

Waterjet Cleaning System Cutting Box **Blaster**

Simple, Effective and Efficient Functionality to Suit Your Needs

Fields of application

- Aerospace
- Automotive
- General industry

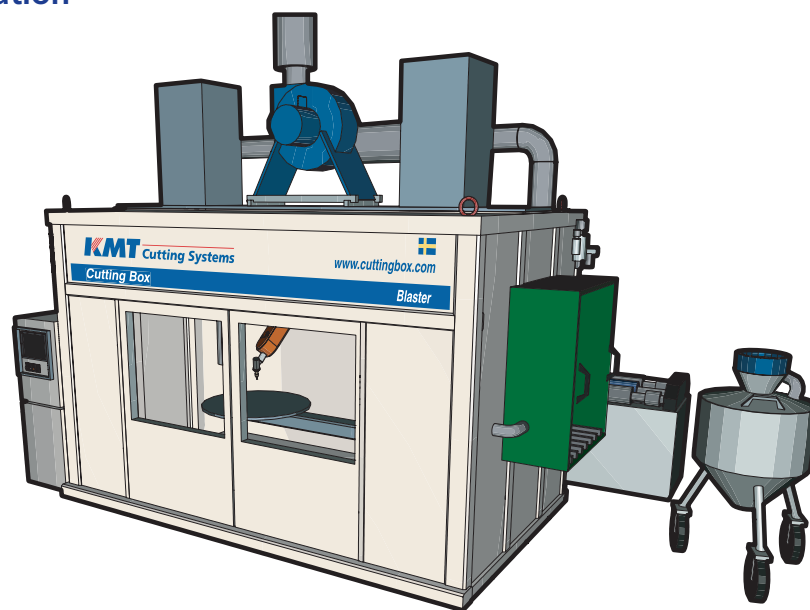

The systems

- Original IV
- Original IV Large
- Compact IV
- Stationary IV
- **Blaster**
- ThreeWing
- FourWing
- FourRob
- Abrasive Stationary
- Routing S
- Routing L

The Cutting Box Blaster

High quality robotised turnkey system for three-dimensional waterjet cleaning and surface treatment. The system is designed to clean surfaces from coating, grease and other substances. The cell can be equipped with a fixed table or rotating dial-tables for maximum flexibility. Garage doors give access to the cell. The system can be equipped with 1 or 2 inverted robots, either fixed or on track motion. As an option abrasive blasting using a mixture of water and sand can be added as a function within the same cell as for cleaning.

3D-Waterjet Cleaning

A waterjet is formed by forcing a fine jet of water through multiple sets of nozzles at very high pressure. The nozzles are mounted at a body that rotates by a pneumatically driven motor. The complete rotojet is a standard KMT Waterjet Systems product. The rotojet unit is mounted at the end of the robot and instead of having steel high-pressure tubing, water to the rotojet is guided through high-pressure flexible hosing to utilize maximum flexibility of the robot.

Fast return on investment

KMT Cutting Systems supplies turnkey systems based on stand-alone platforms with special options for easy customisation, including training, installation and start-up assistance.

The system is:

- Efficient, fast and accurate
- Productive and flexible
- Safe, ergonomic and clean
- Economical and easy to use

Smooth start-up

The system is installed and fully operational within five days.

General features and specifications

- Robot ABB IRB 2400F, degree of protection: IP 67
- KMT Waterjet® Streamline™ high pressure intensifier
- KMT Waterjet Rotojet
- Operator panel with easy to use menus
- Single operator required
- Very compact machine foot-print
- Sound proof enclosure

You get the right machine !

We make sure that you get the best system configuration for your needs.

General scope of supply with accessories

Please notice that all dimensions are stated in mm.

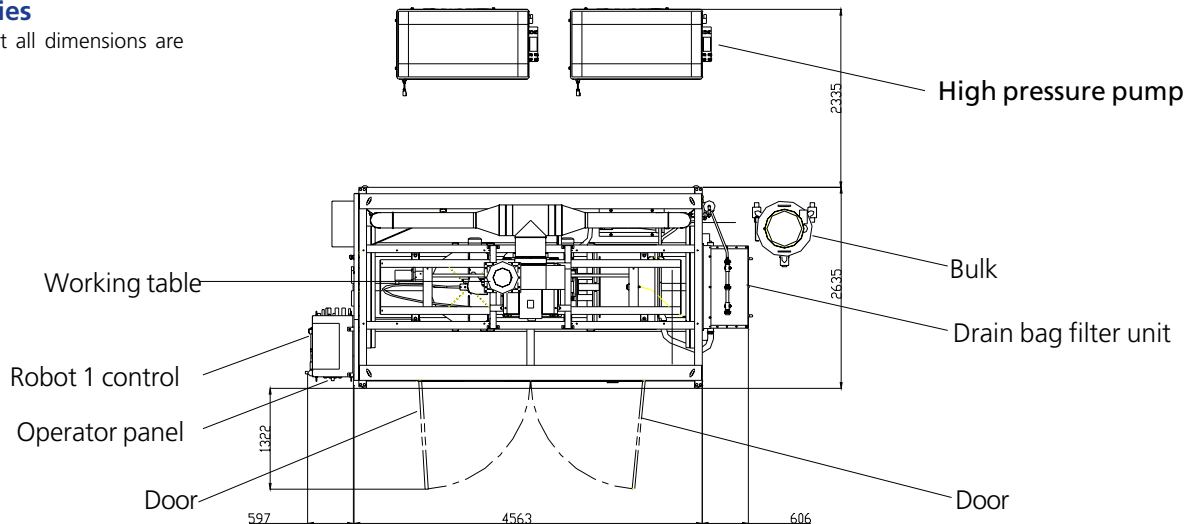

Optional

Greater productivity

- Abrasive blasting function
- Calibration of the Cutting Box
- Off-line programming service
- Fixture integration by KMT Cutting Systems
- Service contract
- Communication with modem

Production friendly

- PC-Robot communication

Additional safety features

- Automatic "block and bleed" valve

info@kmtcutting.com

www.cuttingbox.com



The Cutting Box fully complies with all CE-requirements

Headquarter, Sweden (Your partner for Scandinavia)
Box 529, 372 25 Ronneby
Tel: +46 (0)457 345 00, Fax: +46 (0)457 345 99

Germany (Your partner for Germany, & East Europe)
Schanzenfeldstraße 14b, 35578 Wetzlar
Tel: +49 (0)6441 4459 6-0, Fax: +49 (0)6441 4459 666

United Kingdom (Your partner for United Kingdom, Middle East, India & Africa)
114 Washway Road, Sale, Cheshire M33 7RF
Tel: +44 (0)161 374 0734, Fax: +44 (0)61 374 0738

France (Your partner for France, Spain, Portugal & South America)
121 rue d'Aguesseau, 92100 Boulogne-Billancourt
Tel: +33 (0)1 55 60 18 21, Fax: +33 (0)1 55 60 18 39

China (KMT Machine Tool Ltd, your partner for Asia)
No. 251 Ri Ying Nan Road, Waogaogiao Free Trade Zone, Shanghai, 200131
Tel: +86 (0)21 5048 1965, Fax: +86 (0)21 5048 3965

USA (Your partner for North America)
635 West 12th Street, P.O. Box 231, Baxter Springs, KS 66713
Tel: +01 513 770 0113, Fax: +01 513 770 0113